

BETA SACHS/ZF 48mm FITTING INSTRUCTIONS

117-450-023-001



KEY



NOTE!



CAUTION!



WARNING!



Read the instructions carefully and make sure you understand them before you proceed. If you have any queries please contact your dealer or nearest supplier of K-Tech Suspension immediately.



K-Tech Suspension Ltd. cannot be held responsible for any damage to vehicle, front fork, personal injury or property if the installation instructions are not followed exactly.



Please read this instruction manual before installing this product.



This product should only be installed by an authorised K-Tech Dealer.

- 1 This product is designed and developed for a specific motorcycle model and should only be installed onto the recommended model in its original condition.
- 2 After this product has been installed you should take a low speed test ride to check stability of the vehicle has been maintained.
- 3 Remove and install the front forks from the motorcycle using the manufacturer's workshop manual.

SERVICE

K-Tech Suspension Ltd recommend that this product is serviced after every 30 HOURS of use. It is very important that this product is serviced by an authorised dealer, as there are special tools required to guarantee correct performance of this product. K-Tech Suspension Ltd cannot be held responsible for any damage caused to/by the product if a service is overdue or was not conducted by an authorised dealer.

Set up data

Recommended settings

Compression:	10 clicks
Rebound:	8 clicks
Air gap:	110 mm
Fork position:	Set to owners manual



Strip and fit one piston kit at a time to avoid any errors during installation

REBOUND:

The rebound damping is in the left hand leg and can be indentified by the R on the top cap and has no preload adjuster.

COMPRESSION:

The compression damping is in the right hand leg and can be indentified by the C/P on the top cap and has a preload adjuster.



REBOUND:

The rebound piston assembly consists of a rebound shim stack and mid valve shim stack

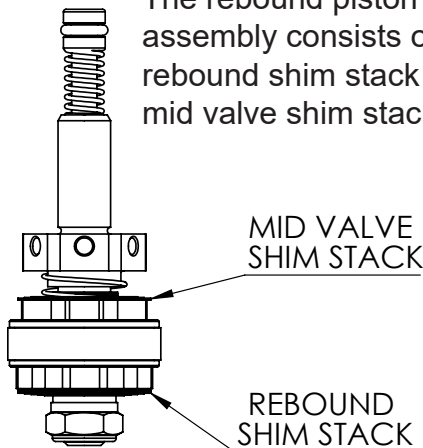

COMPRESSION:

The compression piston assembly consists of a comp shim stack and a check valve

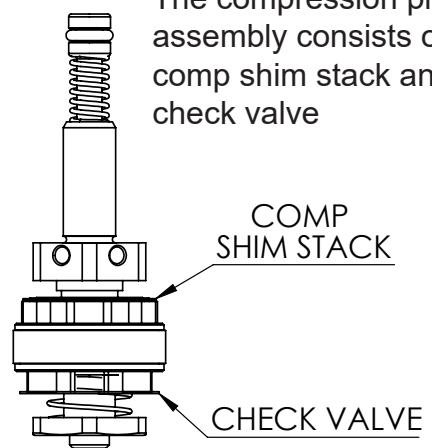

ORVS - Removal

1

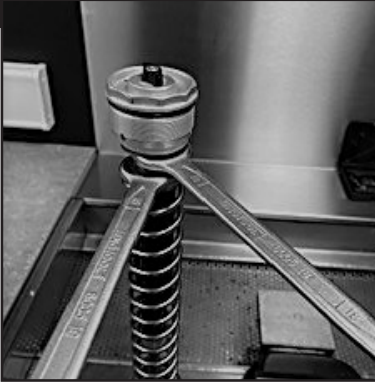

1: Remove the top cap from the piston rod assembly. Remove the main spring and empty fork oil into a suitable container.

2



2: Uncrew the base valve assembly from fork foot using a 17mm hex. Oil remaining in the fork may leak out - have a suitable container to hand.

3



3: Remove the base valve assembly.

4



4: Remove the cartridge from the fork leg.

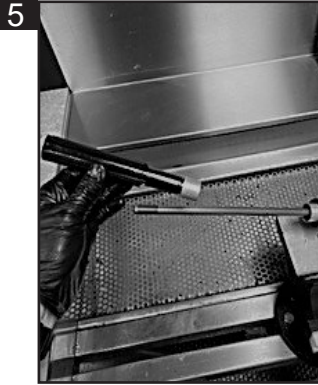

5: Unscrew and remove the spring guide from the piston rod.

6: Remove the clip from the piston rod.

7: Remove the piston rod assembly from the damper tube through the bottom of the tube.



8: Using a 12mm split clamp to hold the piston rod, loosen the piston assembly from piston rod.

9: Remove the piston assembly from the piston rod.

10: **Refer to images on page 3 to ensure the correct piston assembly is fitted to the correct fork leg. The base valve assemblies are the same for both comp and rebound.**

ORVS - Installation



11: Select correct K-Tech piston assembly for fork leg, apply Loctite 2701 to thread and install into piston rod.

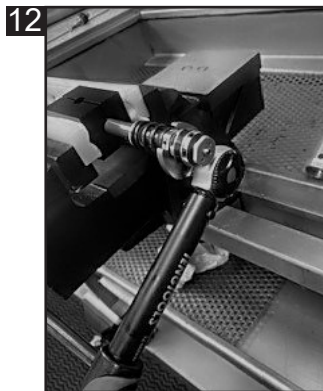

12: Torque piston assembly to 15Nm using 17mm crow foot.

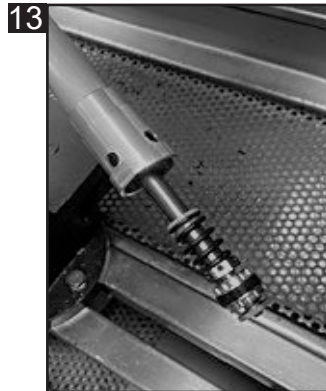

13: Install piston rod assembly in to damper tube through the bottom of the tube.

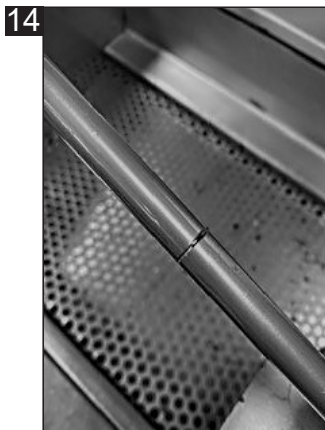

14: Install circlip onto piston rod.



15: Install spring guide on to piston rod and screw down to stop on circlip.



16: Install cartridge assembly into fork leg outer.



17: Install base valve assembly into fork foot. Apply green grease to o-ring.

18: Torque to 50Nm using 17mm hex.

19: Fill the fork with oil within 100mm of the top of the fork. Bleed the system by moving the piston rod up and down around 10 times.



20: Set oil height in the cartridge to 110mm.

21: Install the top cap on to piston rod and torque to 15Nm

22: Pull up the outer tube and screw in top cap. Torque to 10Nm.



www.ktechsuspension.com

Contact your local K-Tech dealer for more details at
www.ktechsuspension.com/service-centres-and-partners