

S48

Suzuki Hayabusa 2021-

Kit for left side

| ID | Description | Cat.No. | Pcs |
|----|----------------------|---------|-----|
| 1 | AL insert M10 | X1 | 1 |
| 2 | Steel adapter | 768 | 1 |
| 3 | Dural. roller l=14mm | 1372 | 1 |
| 4 | Bolt M8x25mm | 831 | 1 |
| 5 | Bolt M10x55mm | 1002 | 1 |
| 6 | Bolt M10x70x1,25mm | 898 | 1 |
| 7 | Dural. roller l=19mm | 1371 | 1 |
| 8 | Tape 3M | | 4 |
| 9 | Washer M10 | 804 | 1 |
| 10 | Washer M8 | 802 | 1 |

Kit for right side

| ID | Description | Cat.No. | Pcs |
|----|------------------------|---------|-----|
| 1 | AL insert M10 | X1 | 1 |
| 2 | Steel adapter | 769 | 1 |
| 3 | Dural. roller l=23mm | 1373 | 1 |
| 4 | Bolt M8x25mm | 831 | 1 |
| 5 | Bolt M10x65mm | 943 | 1 |
| 6 | Bolt M10x65x1,25mm | 945 | 1 |
| 7 | Stick 12(M8)x417x30x30 | | 1 |
| 8 | Tape 3M | | 4 |
| 9 | Washer M10 | 804 | 1 |
| 10 | Washer M8 | 802 | 1 |

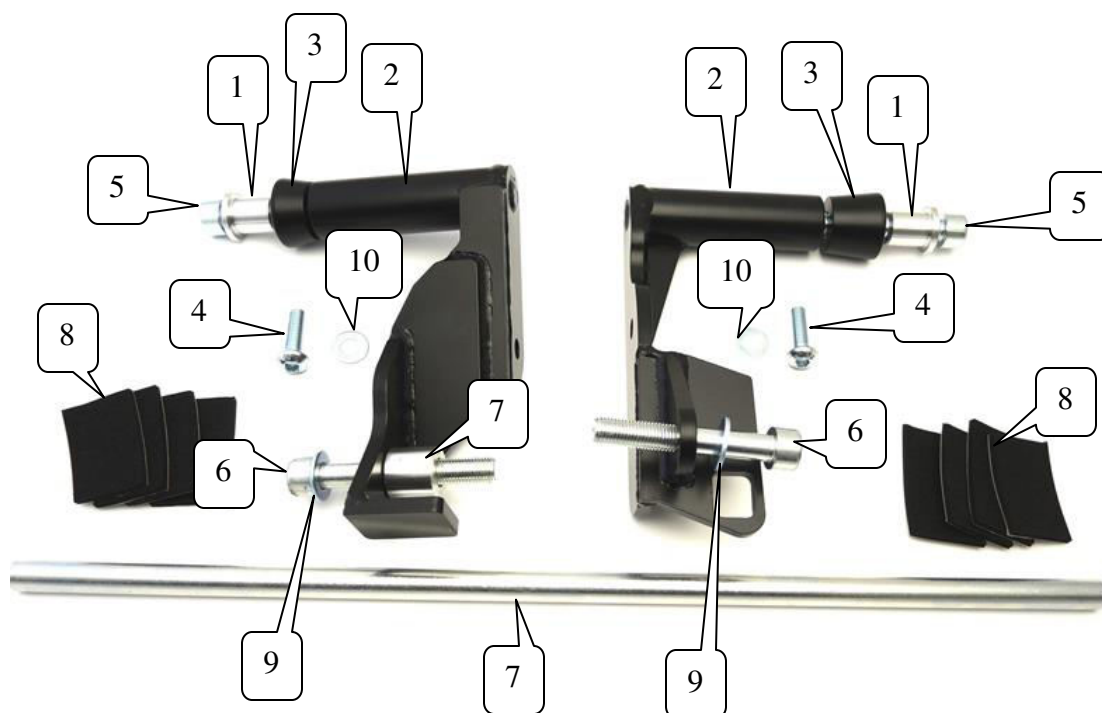

Note: We recommend using medium strenght thread glue during assembly (blue color).

Assembly:

1. Remove the original side plastics.
2. Support the motor so that it does not lower below during installation.
3. Remove the original M10 screw on the left side of the motorcycle frame.
4. Take the left ID.2 adapter and stick 3M ID.8 tape (in contact with the motorcycle frame).
5. Now mount the adapter on the motorcycle frame with screw ID.6 (M10x70x1.25mm) with washer ID.9. Do not forget to thread the duralumin roller ID.7 on the screw (see photos on the first page of the manual, roller length 19mm).
6. Tighten lightly.
7. Take a 12mm ID.7 steel rod (417mm rod length) and pass it over the exhaust pipes between the water cooler and the engine.
8. To secure this rod on the left side, use an ID.4 screw (M8x25mm) with an ID.10 washer. Again, do not tighten completely.
9. Remove the original M10 bolt on the right side and loosen the original M8 bolt on the motorcycle frame.
10. Take the right ID.2 adapter and stick 3M ID.8 tape in it.
11. Now insert this adapter between the motorcycle frame and the engine.
12. Lightly tighten with screw ID.6 (M10x65x1.25mm).
13. Mount the steel bar running from the left side with the screw ID.4 (M8x25mm) with the washer M8 ID.10.
14. Only when you have everything mounted can you tighten all the screws. Use the strenght (Nm) according to the original Suzuki instructions for the bolts holding the motor adapters.
15. Refit the side plastics.
16. Now at a glance you will find that you have steel adapters with M10 threads in the side plastics, these threads are used for mounting crash protectors / sliders.
17. Take the crash protector for the left side, insert the AL insert ID.1 into it and mount it in the steel adapter with the screw ID.5 (M10x55mm). For the correct protector length, use an ID.3 duralumin roller (length 14mm-black) between the protector and the steel adapter.
18. The mounting of the protector on the right side is identical, just use the screw ID.5 (M10x65mm) and the duralumin roller ID.3 (length 23mm-black) just for mounting.

If you have any problems or questions, please contact us by email: info@rdmoto.eu.
Thank you for purchasing our product. Team RDMoto

LEFT SIDE



RIGHT SIDE

