

ELENCO PARTI / PARTS LIST

| # | QTÀ / QTY | DESCRIZIONE / DESCRIPTION | CODICE / CODE |
|----|-----------|--|---------------|
| 1 | 1 | DB killer / DB killer | 50.DK.092.0 |
| 2 | 1 | Silenziatore / Muffler | OVAL 300 |
| 3 | 1 | Protezione in gomma per staffa / Rubber protection for bracket | 50.73.077.1 |
| 4 | 1 | Staffa / Bracket | 50.SS.030.0 |
| 5 | 1 | Vite M8x20 / Screw M8x20 | 50.73.894.1 |
| 6 | 1 | Rondella in alluminio / Aluminium washer | 50.73.063.1 |
| 7 | 1 | Vite M8x40 / Screw M8x40 | 50.73.075.1 |
| 8 | 1 | Rondella alluminio / Aluminium washer | 50.73.291.1 |
| 9 | 1 | Staffa / Bracket | 50.SS.026.0 |
| 10 | 1 | Dado M8 flangiato / Flanged nut M8 | 50.73.393.1 |
| 11 | 1 | Tubo di raccordo / Link pipe | 9773KT024S2 |
| 12 | 1 | Fascetta Ø 48/51 mm / Pipe clamp Ø 48/51 mm | 50.FA.007.1 |
| 13 | 1 | Gommino per molla / Rubber for spring | 50.73.049.0 |
| 14 | 1 | Molla media / Mid-size spring | 50.73.359.1 |

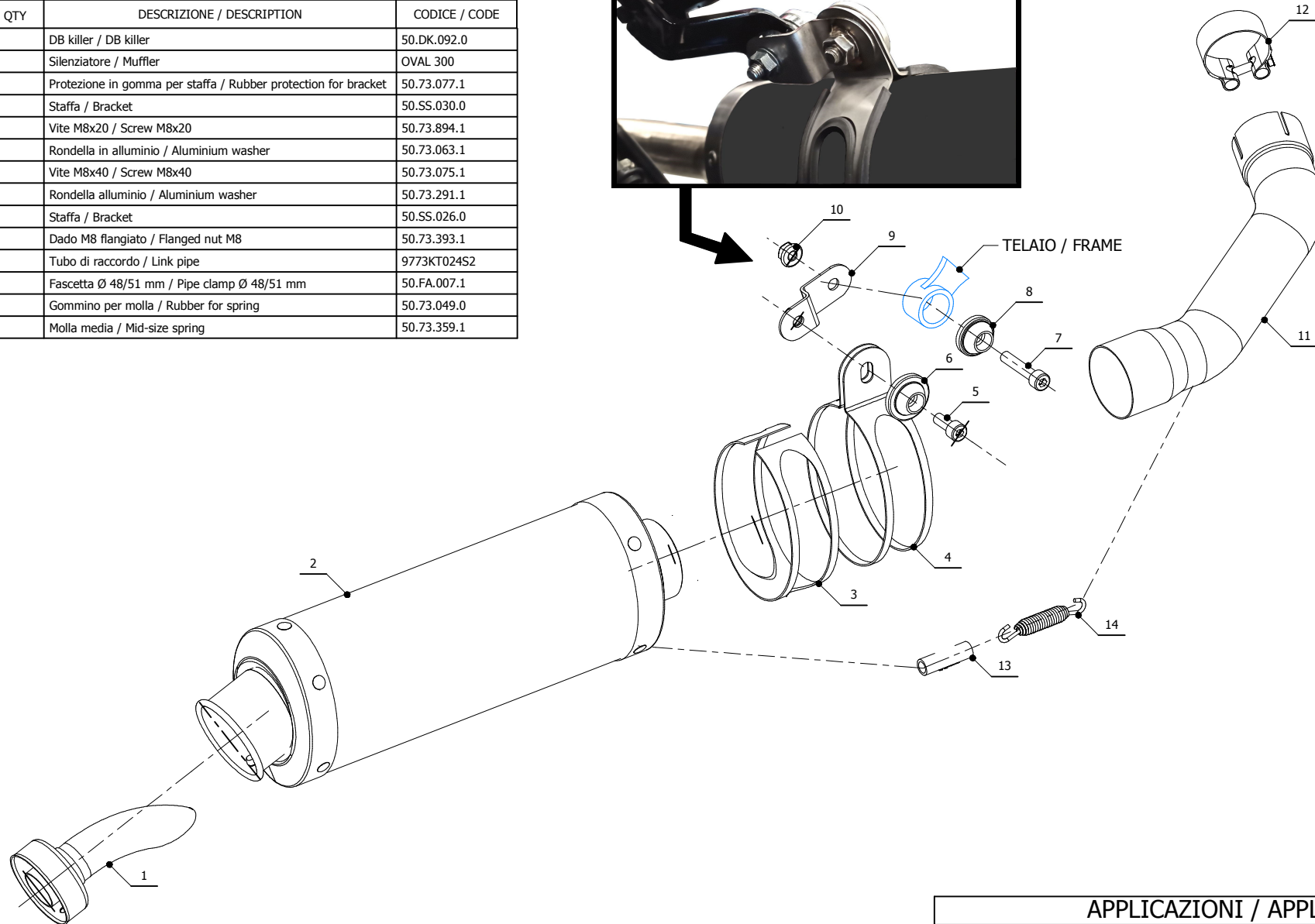

APPLICAZIONI / APPLICATIONS

| CODICE / CODE | SILENZIATORE / MUFFLER | TUBO / PIPE | FASCETTA / CLAMP |
|----------------|------------------------|------------------|------------------|
| 74.KT.024.LX1 | INOX / ST. STEEL | INOX / ST. STEEL | INOX / ST. STEEL |
| 74.KT.024.LX1B | STEEL BLACK | | |