

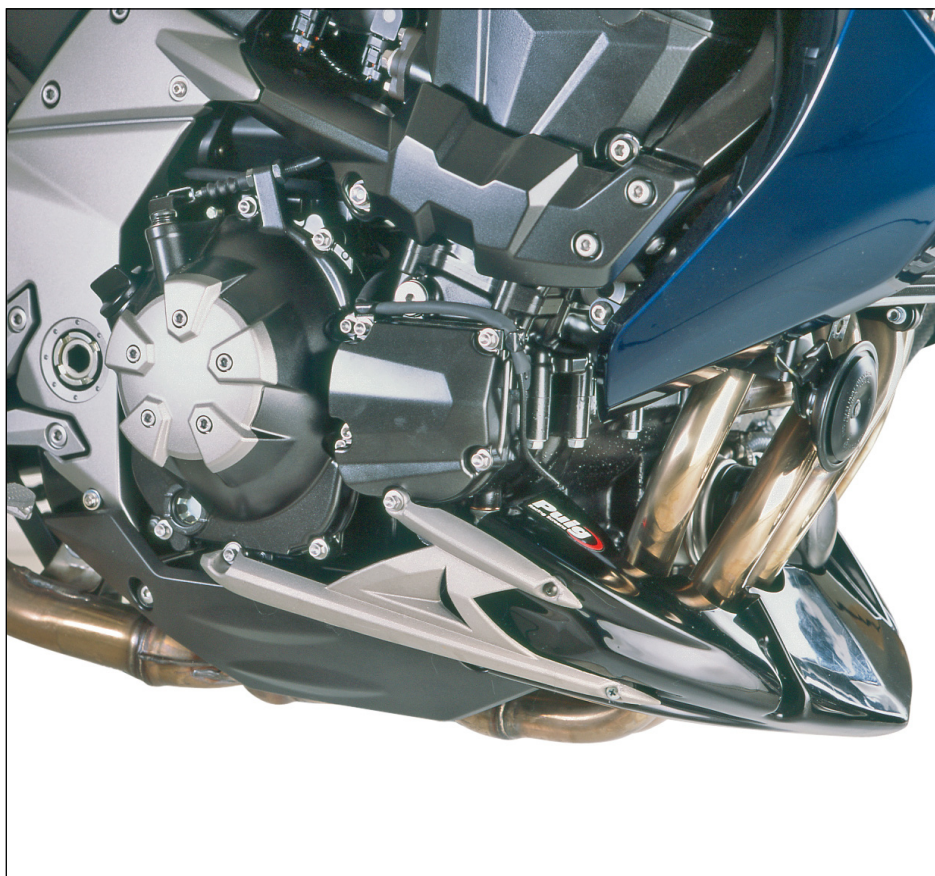

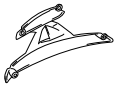





QUILLA ADAPTABLE PARA - ENGINE SPOILER FOR - BUGSPOILER FÜR

KAWASAKI Z750 '07- '12 / Z750R '11- '12
Z1000 '07- '09



Ref.: 4525

ID	PIEZA / PART	DESCRIPCIÓN	DESCRIPTION	QTY	REF.
1		Quilla	Engine spoiler	1	4525C/NM3
2		Soporte derecho aluminio	Right aluminium support	1	SOPORFU-2P-4525
3		Soporte izquierdo aluminio	Left aluminium support	1	SOPORFU-2P-4525
4		Soporte izquierdo INOX	Left metal support INOX	1	SOPOR-1P-2-4525
5		Silemblock M5 (se suministra montado en la pieza nº1)	M5 well nut (supplied already mounted on the piece nº1)	4	SILENBTM5-046/1
6		Tornillo Allen M5x20 ISO 7380	M5x20 ISO 7380 Allen screw	2	TORNIAI7380-387
7		Tornillo Allen M5x25 ISO 7380	M5x25 ISO 7380 Allen screw	2	TORNI-I7380-477
8		Tornillo Allen M6x20 DIN912	M6x20 DIN912 Allen screw	1	TORNI-AD912-489
9		Tuerca M6 grafilada	Special M6 nut	1	TUERCAEM6G-0213
10		Conjunto adhesivos (ver anexo)	Stickers set (annexe)	1	ADHESI-VB4T-176

QUILLA ADAPTABLE PARA - ENGINE SPOILER FOR - BUGSPOILER FÜR
KAWASAKI Z750 '07- '12 / Z750R '11- '12
Z1000 '07- '09

INSTRUCCIONES DE MONTAJE - MOUNTING INSTRUCTIONS - MONTAGEANLEITUNG

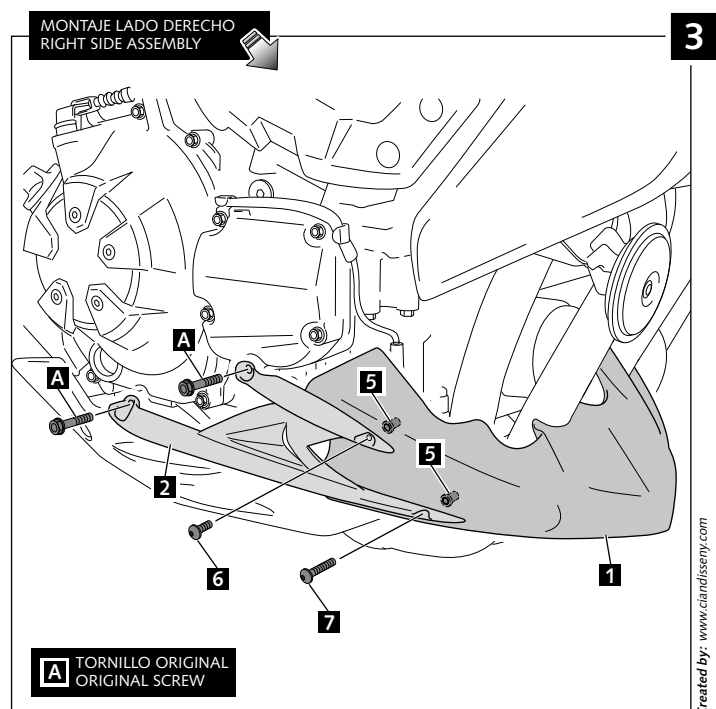
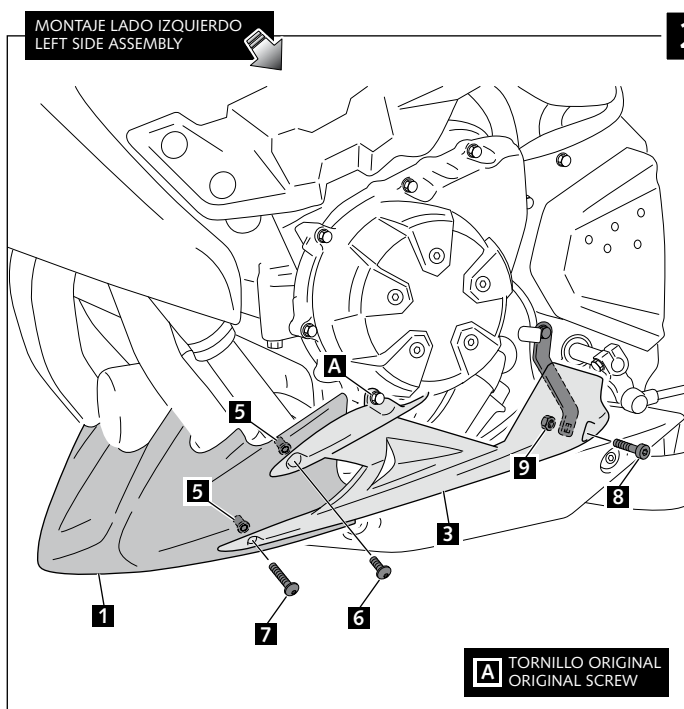
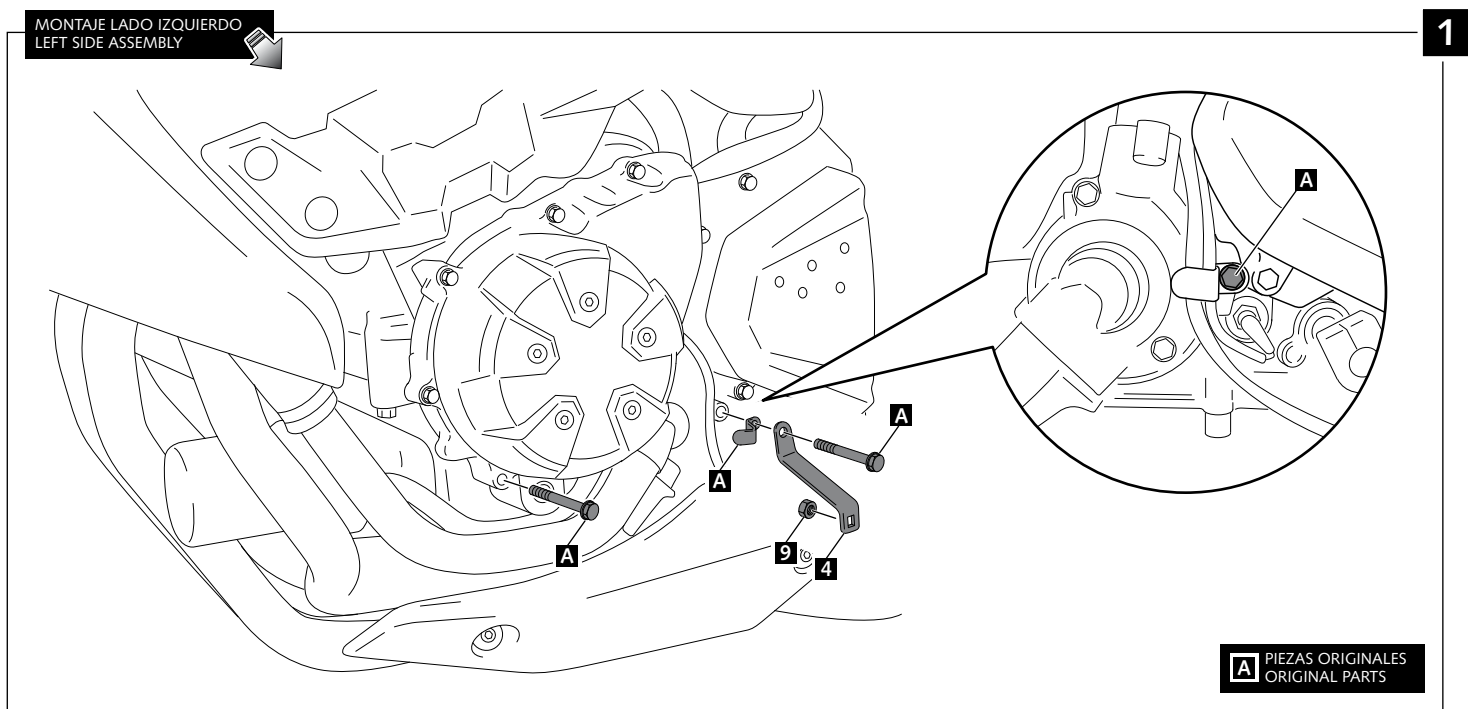

QUILLA ADAPTABLE PARA - ENGINE SPOILER FOR - BUGSPOILER FÜR
KAWASAKI Z750 '07- '12 / Z750R '11- '12
Z1000 '07- '09

INSTRUCCIONES DE MONTAJE - MOUNTING INSTRUCTIONS - MONTAGEANLEITUNG

